

Buffet display SW10KP



Description

The buffet cabinet keeps foods hygienically fresh and cool. With its cold packs, it's not dependent on a fixed power source and can be placed freely at your buffet. The transparent roll-top lid allows serving from both sides along with a direct view of the treats being presented.

Features

- | | |
|---------------------------|--|
| • Colour: | Black |
| • Material: | Stainless steel
Plastic |
| • Number of levels: | 1 |
| • Important information: | - |
| • Refrigeration function: | 2 cooling pads
Stainless steel plate, removable |
| • Operation: | On both sides |
| • Hood: | Detachable
Polystyrene |
| • Dimensions surface: | W 420 x D 270 mm |
| • Properties: | Simple cleaning
Easy disassembly |
| • Size: | W 463 x D 315 x H 195 mm |
| • Weight: | 2.93 kg |



▶ 1-level buffet cabinet

- ✓ Utility surface: Stainless steel sheet, removable
- ✓ Utility surface dimensions: W 420 x D 270 mm

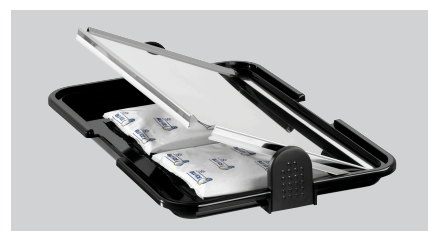

▶ Refrigeration function using 2 cold packs

- ✓ Stainless steel sheet for good temperature transfer



▶ Roll-top lid that can be opened from both sides

- ✓ Transparent

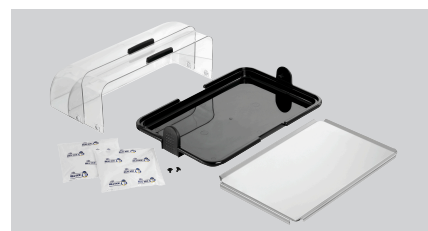

▶ Easy cleaning

- ✓ Simple disassembly