



A135009

Original-Gebrauchsanleitung
V3/0120

1. General Information	14
1.1 Information about the instruction manual	14
1.2 Key to symbols	14
1.3 Liability and Warrantees	15
1.4 Copyright protection	15
1.5 Declaration of conformity	15
2. Safety	16
2.1 General information	16
2.2 Safety instructions for use of the device	16-17
2.3 Intended use	17
3. Delivery, packaging and storage	18
3.1 Delivery check	18
3.2 Packaging	18
3.3 Storage	18
4. Technical data	19
4.1 Technical specification	19
4.2 Overview of parts	19
5. Installation and operation	20
5.1 Safety instructions	20
5.2 Installation and connection	20-21
5.3 Operating	21-22
6. Cleaning and maintenance	23
6.1 Safety advice	23
6.2 Cleaning	23
6.3 Safety instructions for maintenance	24
7. Waste disposal	24

Bartscher GmbH
Franz-Kleine-Str. 28
33154 Salzkotten
Germany

phone: +49 5258 971-0
fax: +49 5258 971-120
Service-Hotline: +49 5258 971-197
www.bartscher.com

1. General information

1.1 Information about the instruction manual

This instruction manual contains information about the installation, operation and maintenance of the device and should be consulted as an important source of information and reference guide.

Awareness of the safety instructions and instructions for use in this manual will ensure the safe and correct use of the device.

In addition to the information given here, you should comply with any local Health and safety Controls and generally applicable safety regulations.

The instruction manual forms part of the product and should be kept near the device and easily accessible for anyone carrying out the installation, servicing, maintenance or cleaning.

1.2 Key to symbols

In this manual, symbols are used to highlight important safety instructions and any advice relating to the device. The instructions should be followed very carefully to avoid any risk of accident, personal injury or material damage.



WARNING!

This symbol highlights hazards, which could lead to injury.

Please follow the instructions very carefully and proceed with particular attention in these cases.



WARNING! Electrical hazard!

This symbol draws attention to potential electrical hazards. If you do not follow the safety instructions, you may risk injury or death.



CAUTION!

This symbol highlights instructions, which should be followed to avoid any risk of damage, malfunctioning and/or breakdown of the device.



NOTE!

This symbol highlights tips and information, which have to be followed for an efficient and trouble-free operation of the device.

1.3 Liability and Warrantees

All the information and instructions in this manual take into account standard safety regulations, current levels of technical engineering as well as the expertise and experience we have developed over the years.

The instruction manual was translated with all due care and attention. However, we do not accept liability for any translation errors. The German version of this instruction manual is definitive.

If the delivery consists of a special model, the actual scope of delivery may differ from the descriptions and illustrations in this manual. This is also the case for special orders or when the device has been modified in line with new technology. If you have any questions, you should contact the manufacturer.



NOTE!

Read the instruction manual carefully before using the device. The manufacturer does not accept liability for any damage or malfunction resulting from not following the instructions for use.

The instruction manual should be kept near the device, easily accessible for anyone wishing to work with or using it. We reserve the right to make technical changes for purposes of developing and improving the useful properties.

1.4 Copyright protection

The instruction manual including any texts, drawings, images or other illustrations is copyright. No part of this publication may be reproduced, transmitted or used in any form or by any means without permission in writing from the manufacturer. Any person who commits any unauthorized act in relation to this publication shall be liable to claims for damages. All rights reserved.



NOTE!

The contents, texts, drawings, pictures and any other illustrations are copyright and subject to other protection rights. Any person unlawfully using this publication is liable to criminal prosecution.

1.5 Declaration of conformity

The device complies with the current standards and directives of the EU.

We certify this in the EC declaration of conformity.

If required we will be glad to send you the according declaration of conformity.

2. Safety

This section provides an overview of all important safety aspects.

In addition every chapter provides precise safety advice for the prevention of dangers which are highlighted by the use of the above mentioned symbols.

Furthermore, attention should be paid to all pictograms, markers and labels on the device, which must be kept in a permanent state of legibility.

By following all the important safety advice you gain an optimal protection against all hazards as well as the assurance of a safe and trouble-free operation.

2.1 General Information

This device is designed in accordance with the presently applicable technological standards. However, the device can pose a danger if handled improperly and inappropriately.

Knowing the contents of the instruction manual as well as avoiding mistakes and thus operating this device safely and in a fault-free manner is very essential to protect yourselves from the hazards.

To prevent hazards and to ensure optimum efficiency, no modifications or alterations to the device that are not explicitly approved by the manufacturer may be undertaken.

This device may only be operated in technically proper and safe condition.

2.2 Safety instructions for use of the device

The specifications regarding the industrial safety are based on the Regulations of the European Union applicable at the time of manufacturing the device.

If the device is used commercially, the user is obliged to ensure that the said industrial safety measures concur with the state of the rules and regulations applicable at the time in question for the entire period of use of the device and to comply with the new specifications.

Outside the European Union, the industrial safety laws applicable at the place of installation of the device and the regional territorial provisions must be complied with.

Besides the industrial safety instructions in the instruction manual, the general safety and accident prevention regulations as well as environment protection regulations applicable for area of application of the device must be followed and complied with.



CAUTION!

- The device is not intended for use by individuals (including children) with physical or mental disabilities, insufficient experience, and/or insufficient knowledge unless such persons are under the care of a person responsible for their safety or have received instructions regarding appropriate use of the device.
- Children should be observed to ensure that they are not playing with the device.
- Preserve this manual safely. When passing on/selling the device to a third party, the manuals must be handed over along with the device.
- Every person using the device must act in accordance to the manuals and under consideration of the safety advice.
- The device is to be used indoors only.

2.3 Intended use



ATTENTION!

The unit is designed and produced only for domestic use and is not intended for industrial application!

Safe operation is only guaranteed when using the device for its intended purpose.

Any technical interventions, as well as assembly and maintenance are to be made by a qualified customer service only.

The Mixer/Blender is intended for chopping and grating fruits and vegetables into puree.



CAUTION!

Any use going beyond the intended purpose and/or any different use of the device is forbidden and is not considered as conventional.

Any claims against the manufacturer or his authorized representative as a consequence of experiencing damages resulting from unconventional use are impossible.

The operator is liable for all damages resulting from inappropriate use.

3. Transport, packaging and storage

3.1 Delivery check

Please check the delivery upon completeness and transport damage immediately after receipt. In case of visible damage do not accept or accept the delivery with reservation only.

Note the extent of damage on the carrier's bill of delivery. Trigger off the complaint.

Hidden damages should be reclaimed immediately after notice, as claims for damages can only be asserted within the effective period for complaints.

3.2 Packaging

Please do not throw away the covering carton of your device as it might be useful for storage purposes, when moving or, in case of damages, when the device must be sent back to a repair center. The outer and inner packing material should be removed completely from the device before installation.



NOTE!

If you liked to dispose the packing, consider the regulations applicable in your country. Supply re-usable packing materials to the recycling.

Please inspect the device upon completeness. In case any part is missing please contact our customer service center immediately.

3.3 Storage

Keep the package closed until installation and under consideration of the outside indicated positioning- and storage markings.

Packages should be stored under consideration of the following:

- Do not store outdoors.
- Keep it dry and dust-free.
- Do not expose it to aggressive media.
- Do not expose it to direct sunlight.
- Avoid mechanical shocks and vibration.
- In case of longer storage (> 3 months) make sure you check the state of the packaging and the parts regularly.
If required refresh or renew.

4. Technical data

4.1 Technical specification

Name	Mixer / Blender
Article no.:	A135009
Cutting blades:	Stainless steel
Speeds:	2, max. 16000 RPM
Power:	0,4 kW / 230 V / 50 Hz
Dimensions:	Ø 220 mm, H 420 mm
Glass pitcher capacity:	1.75 litres
Weight:	3.6 kg

We reserve the right to make technical changes!

4.2 Overview of parts

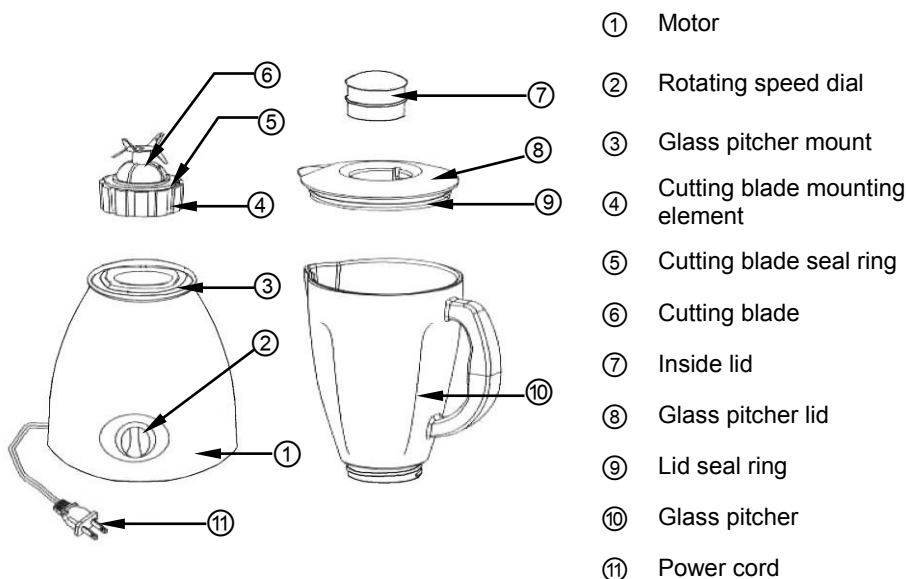

5. Installation and operation

5.1 Safety instructions



WARNING! Electrical hazard!

The device must only be connected to a properly installed single socket with protective contact.

Never yank cord to disconnect from outlet.

Cable must not touch any hot parts.

- See that the cable does not touch any heat sources or sharp edges. Do not let the cable dangle over the counter edge.
- Do not use the device in case it does not function properly, has been damaged or dropped.
- Do not use any accessory or spare parts that have not been recommended by the manufacturer. These can be dangerous for the user or lead to damages of the device or personal injury, and further, the warranty expires.
- Do not lay the cable over carpets or heat insulations. Do not cover the cable. Keep away the cable from operating range and do not dunk it into water.
- Do not move or tilt the device when in operation.



WARNING! Hazard via electrical current!

The device can cause injuries due to improper installation!

Before installation the local power grid specification should be compared with that of the device (see type label).

Connect the device only in case of compliance!

Take note of the security advice!

5.2 Installation and connection

- Unpack the unit and remove all packing material.
- Put the unit in a flat, safe place that can support its weight and remain stable.
- Use the unit on a smooth, clean and dry surface that the suction cups at the base of the unit can attach themselves to.
- Not **at any time** should you place the device on an inflammable surface (such as: table cloth, carpet, etc.).
- You must not position the device near open fireplaces, electric ovens/arc furnaces, furnaces/electric heaters or other heat sources.

- The electrical circuit in the socket must be secured to at least 16A. Only connect the device directly to the wall socket; do not use any extension cords or power strips.
- Place the device so that the plug is easily accessible and can be quickly removed from its socket in case of necessity.

5.3 Operating

- Clean the unit prior to use. Follow the instructions in **6.2 "Cleaning"**.
- Fix the seal ring onto the cutting blade. Turn the glass pitcher upside-down. Place the cutting blade inside the glass pitcher with the sharp edges facing down. Set the position of the cutting blade in the glass pitcher using the mounting element.



CAUTION!

Remember to ensure that the cutting blade is securely mounted in the glass pitcher before placing the pitcher on the motor.

- Mount the glass pitcher and cutting blade on the motor.
- Prepare the fruits and vegetables to be mixed. Cut them into small pieces.
- Fill the glass pitcher with the prepared fruits/vegetables.



CAUTION!

Do not mix any hot liquids or dishes with a temperature above 80 °C in the glass pitcher. The glass pitcher may burst and cause injuries!

- Place the lid on the glass pitcher. Insert the internal lid into the pitcher lid's opening and close it by turning the internal lid. Always close the glass pitcher and internal lid before activating the unit.
- Connect the unit to a single grounded outlet.
- Select the desired speed using the rotating dial (**1** or **2**) in accordance with the ingredients to be mixed.
 - Level **1** – low speed
 - Level **2** – high speed
 - Pulsating mode  (turn the dial to the left) is only for chopping for a short length of time.



- The unit should not operate for long periods without a break. The unit chops food very quickly. Check the consistency of the ingredients after a few seconds and turn the unit back on if necessary when it cools down.



CAUTION!

Leave the unit to cool down after each mixing!

- Do not chop large quantities of hard or frozen ingredients together. For best results, chop such products in smaller portions.
- If the blade is stuck and the motor malfunctions, turn the unit off immediately, remove the unit's plug from its socket and remove some of the food from the glass pitcher. Continue mixing.
- Do not overfill the glass pitcher; the filling level can be viewed using the markings on the glass pitcher's side. Do not exceed the maximum level, especially when mixing hot or foamy ingredients and when the unit is operating at high speeds.
- When water is added the unit can chop ice cubes (max. 3-4 cubes), which can then be used to make cocktails. Add 1 cup of water to the ice cubes for best results. Turn the rotating dial to pulsating several times.



WARNING! Risk of injury!

Never place hands or any object inside the unit while in use!

When mixing, do not use any objects to push ingredients down in the glass pitcher. They can get caught in the blade and lead to damage of the unit or injury to the person operating it!

- When the ingredients achieve the desired consistency, turn the dial to the position marked "0" and remove the glass pitcher from the motor after it has shut off.



CAUTION!

The unit is equipped with a safety function which ensures that the unit can be activated only when the glass pitcher is properly mounted. When the glass pitcher is removed from the motor, the unit shuts off.

- Turn the dial to the position marked "0" and remove the unit's plug from its socket if it is to remain unused.

6. Cleaning and maintenance

6.1 Safety advice

- Before beginning with repair or cleaning works make sure the device has been disconnected from power socket (pull the power plug!) and has cooled down.
- Do not use any acid agents and make sure no water ingresses the device.
- To protect yourself from electric shock, **never** immerse the device, its cables and the plug in water or other liquids.



CAUTION!

The device is not suited for direct washing via water jets. Therefore, you must not use any kind of pressure water jet for cleaning the device!

6.2 Cleaning

- Clean the motor with a soft, moist cloth and mild cleaning agent.



CAUTION!

Never immerse the motor in water or other liquids, nor place under running water or in the dishwasher.

Wipe the motor only with a moist cloth.

- Remove the cutting blade to wash the glass pitcher. Remove the cutting blade mounting element from the glass pitcher by turning it counter-clockwise.
- Remove the seal ring from the cutting blade. Wash the sealing ring and cutting blade in hot water and a mild cleaning agent. For best results clean the blades with a brush. Rinse in clean water.



WARNING! Risk of injury!

The cutting blade is very sharp. Do not touch it. Mount and remove the cutting blade with caution.

- Clean the glass pitcher after each use with a mild cleaning agent, then rinse in clean water.
- Leave all the cleaned elements to dry.
- Use only a soft cloth and **never** use any harsh cleaning agents, sponges or other abrasive tools, nor abrasive chemicals containing acetone or petrol.
- After cleaning, use a soft and dry cloth to dry and polish the unit's surface.

6.3 Safety instructions for maintenance

- Check the mains connection cable for damage from time to time. Never operate the device when the cable is damaged. A damaged cable must immediately be replaced by customer service or a qualified electrician to avoid dangers.
- In case of damage or malfunction, please contact your stockist or our customer service centre.
- Only a qualified technician and using original spare parts and accessories should carry out repairs and maintenance of the device. **Do not attempt to repair the device yourself.**

7. Waste disposal

Discarding old devices

At the end of its service life the discarded device has to be disposed in accordance with the national regulations. It is advisable to contact a company which is specialized in waste disposal, or just contact the local disposal service in your community.



WARNING!

To exclude any abuse and the dangers involved make the waste device unfit for use before disposal. For that purpose disconnect device from mains supply and remove mains connection cable from the device.



NOTE!



For the disposal of the device please consider and act according to the national and local rules and regulations.

Bartscher GmbH
Franz-Kleine-Str. 28
33154 Salzkotten
Germany

phone: +49 5258 971-0
fax: +49 5258 971-120
Service-Hotline: +49 5258 971-197
www.bartscher.com