

**„Bartscher PRO“****150137**

**ENGLISH**

**Table of contents**

<b>1. Safety .....</b>	<b>22</b>
1.1 Key to symbols .....	22
1.2 Safety instructions .....	23
1.3 Proper use .....	26
<b>2. General information .....</b>	<b>27</b>
2.1 Liability and Warrantees .....	27
2.2 Copyright protection .....	27
2.3 Declaration of conformity .....	27
<b>3. Transport, packaging and storage.....</b>	<b>28</b>
3.1 Delivery check .....	28
3.2 Packaging.....	28
3.3 Storage.....	28
<b>4. Technical data .....</b>	<b>29</b>
4.1 Technical specification .....	29
4.2 About the juice extractor.....	29
4.3 Overview of parts .....	30
<b>5. Installation and operation.....</b>	<b>31</b>
5.1 Assembly.....	31
5.2 Installation .....	33
5.3 Operation.....	34
<b>6. Cleaning .....</b>	<b>37</b>
<b>7. Possible Malfunctions .....</b>	<b>39</b>
<b>8. Waste disposal .....</b>	<b>40</b>

Bartscher GmbH  
Franz-Kleine-Str. 28  
33154 Salzkotten  
Germany

phone: +49 (0) 5258 971-0  
fax: +49 (0) 5258 971-120



**Read this instruction manual before using and keep them available at all times!**

This instruction manual contains information about the installation, operation and maintenance of the device and should be consulted as an important source of information and reference guide.

Awareness of the safety instructions and instructions for use in this manual will ensure the safe and correct use of the device.

In addition to the information given here, you should comply with any local Health and safety Controls and generally applicable safety regulations.

The instruction manual forms part of the product and should be kept near the device and easily accessible for anyone carrying out the installation, servicing, maintenance or cleaning.

Please keep these instructions and give them to future owners of the device.

## 1. Safety

This device is designed in accordance with the presently applicable technological standards. However, the device can pose a danger if handled improperly and inappropriately.

All persons using the device must follow the recommendations and instructions in this instruction manual.

### 1.1 Key to symbols

In this manual, symbols are used to highlight important safety instructions and any advice relating to the device. The instructions should be followed very carefully to avoid any risk of accident, personal injury or material damage.



**WARNING!**

This symbol highlights hazards which could lead to injury.



**WARNING!**

This symbol highlights dangerous situations which could lead to injury or death.



### CAUTION!

This symbol highlights dangerous situations which could lead to light injuries, or damage, malfunction, and/or destruction of the device.



### NOTE!

This symbol highlights recommendations and information aimed for effective and trouble-free device operation.

## 1.2 Safety instructions

- The device is not intended for use by individuals (including children) with physical or mental disabilities, insufficient experience, and/or insufficient knowledge unless such persons are under the care of a person responsible for their safety or have received instructions regarding appropriate use of the device.
- Children should be observed to ensure that they are not playing with the device.
- **Never** leave the device unattended when in use.
- Only use the device indoors.
- This device may only be operated in technically proper and safe condition.
- Prevent access of children to the package materials like plastic bags and foamed polystyrene elements. **Suffocation hazard!**
- Only a qualified technician and using original spare parts and accessories should carry out repairs and maintenance of the device. **Do not attempt to repair the device yourself.**

- Do not use any accessory or spare parts that have not been recommended by the manufacturer. These can be dangerous for the user or lead to damages of the device or personal injury, and further, the warranty expires.
- To prevent hazards and to ensure optimum efficiency, no modifications or alterations to the device that are not explicitly approved by the manufacturer may be undertaken.



## **DANGER! Electric shock hazard!**

To avoid the hazard results please follow the safety instructions below.

- Never allow the power cable to come into contact with heat sources or sharp edges. The power cable should not hang over the side of the working surface. Ensure that no one can step on or trip over the cable.
- The power cable must not be folded, bent or tangled, and must always remain fully unrolled. Never place the device or other objects on the power cable.
- Do not lay the power cable over carpets or other inflammable materials. Do not cover the cable. Keep away the cable from operating range.
- Check the power cord regularly for damage. Do not use the device if the power cord is damaged. If this cable is damaged, it must be replaced by customer service or a qualified electrician in order to avoid dangers.
- The supply cable must be disconnected from the socket only by pulling the plug.

- Never carry or lift the device by the supply cable.
- In any case do not open the device housing. In case of electrical or mechanical modifications the **electric shock hazard** will occur.
- Do not use any acid agents and make sure no water ingresses the device.
- **Never** operate the device with moist hands or standing on wet floor.
- Remove the plug from its socket:
  - when the device is not used,
  - in case of anomalies during operation,
  - before cleaning.



### **WARNING! Danger of injury!**

To avoid injury, follow the safety instructions below.

- During the device operation, **never** place hands, spoons or any other kitchen utensils in the feed chute. They may get caught by the sieve, resulting in cuts, broken bones or other physical injuries.
- The knives in the sieve are very sharp. To avoid injury, do not touch them with bare hands.
- Do not touch any moving parts of the device.
- After switching off the device, the motor remains rotating for a few seconds. The device can be opened and its elements removed only after coming to a complete stop.



## CAUTION!

To avoid possible damage to the device, follow the instructions below.

- To avoid damage to the motor base or other parts of the device, do not move or shake the device when in operation.
- Do not use the device if any part is damaged or has visible cracks.
- **Never** clean the motor base or power cable under running water or any other fluids, clean these parts only with a moist cloth and make sure that no liquids get inside the motor housing or inside the plug. **Never** clean the **motor base** in the dishwasher.

## 1.3 Proper use

The operational safety of the device is assured only in case of proper use, according to the operation manual.

All technical activities like installation and maintenance must be performed by the qualified service personnel only.

The juice extractor is designed only for **producing fruit and vegetable juices**.



## CAUTION!

Any use going beyond the intended purpose and/or any different use of the device is forbidden and is not considered as conventional.

Any claims against the manufacturer or his authorized representative as a consequence of experiencing damages resulting from unconventional use are impossible.

The operator is liable for all damages resulting from inappropriate use.

## 2. General information

### 2.1 Liability and Warrantees

All the information and instructions in this manual take into account standard safety regulations, current levels of technical engineering as well as the expertise and experience we have developed over the years.

The instruction manual was translated with all due care and attention. However, we do not accept liability for any translation errors. The German version of this instruction manual is definitive.

If the delivery consists of a special model, the actual scope of delivery may differ from the descriptions and illustrations in this manual. This is also the case for special orders or when the device has been modified in line with new technology.



#### **CAUTION!**

**Read this manual carefully and thoroughly before any operation of the device, and especially before turning it on!**

Manufacturer **is not liable** for any damages or faults caused by:

- violation of advice concerning operation and cleaning;
- use other than designed;
- alterations made by user;
- use of inadequate spare parts.

We reserve the right to make technical changes for purposes of developing and improving the useful properties.

### 2.2 Copyright protection

The instruction manual including any texts, drawings, images or other illustrations is copyright. No part of this publication may be reproduced, transmitted or used in any form or by any means without permission in writing from the manufacturer. Any person who commits any unauthorized act in relation to this publication shall be liable to claims for damages. All rights reserved.



#### **NOTE!**

**The contents, texts, drawings, pictures and any other illustrations are copyright and subject to other protection rights. Any person unlawfully using this publication is liable to criminal prosecution.**

### 2.3 Declaration of conformity



The device complies with the current standards and directives of the EU. We certify this in the EC declaration of conformity. If required we will be glad to send you the according declaration of conformity.



## 3. Transport, packaging and storage

### 3.1 Delivery check

Please check the delivery upon completeness and transport damage immediately after receipt. In case of visible damage do not accept or accept the delivery with reservation only.

Note the extent of damage on the carrier's bill of delivery. Trigger off the complaint.

Hidden damages should be reclaimed immediately after notice, as claims for damages can only be asserted within the effective period for complaints.

### 3.2 Packaging

Please do not throw away the covering carton of your device as it might be useful for storage purposes, when moving or, in case of damages, when the device must be sent back to a repair center. The outer and inner packing material should be removed completely from the device before installation.



#### **NOTE!**

**If you liked to dispose the packing, consider the regulations applicable in your country. Supply re-usable packing materials to the recycling.**

Please inspect the device upon completeness. In case any part is missing please contact our customer service center immediately.

### 3.3 Storage

Keep the package closed until installation and under consideration of the outside indicated positioning- and storage markings.

Packages should be stored under consideration of the following:

- do not store outdoors,
- keep it dry and dust-free,
- do not expose it to aggressive media,
- do not expose it to direct sunlight,
- avoid mechanical shocks and vibration,
- in case of longer storage (> 3 months) make sure you check the state of the packaging and the parts regularly, if required refresh or renew.

## 4. Technical data

### 4.1 Technical specification

Name	Juice extractor "Bartscher PRO"
Code-No.	150137
Body material:	Stainless steel, plastic
Construction:	<ul style="list-style-type: none"><li>▪ XXL feed chute, Ø 83 mm</li><li>▪ Rotation / min: max 3.000</li><li>▪ Micro perforated stainless steel sieve for perfect taste of fruit</li><li>▪ Capacity of pulp container: 7 litres</li><li>▪ Safety switch</li><li>▪ Thermal motor safety</li></ul>
Power:	0.7 kW / 220-240 V 50/60 Hz
Dimensions:	W 260 x D 430 x H 530 mm
Weight:	12.8 kg

We reserve the right to make technical changes!

### 4.2 About the juice extractor

With the electric **juice extractor "Bartscher PRO"** you can professionally produce juice from fruits and vegetables.

The lid with the integrated, very lagged **XXL feed chute** with a diameter of 83 mm, significantly improves the process of preparation.

**The big 7 liter pulp container** lets you squeeze a lot of juice without interruption. When the pulp container fills up, just remove it and empty it without a need to disassemble the device.



The lid of the juice extractor is held by the **locking arm with housing**, which allows – if the device is correctly assembled – to close the motor circuit thanks to the integrated **safety switch**. Only then it is possible to switch the device on. The safety switch immediately stops the motor, when the locking arm with housing is released.

The device is equipped with the **overheating protection**. When the device overheats from being used for too long or from being overloaded, it is switched off automatically, and after cooling off (ca. 15 minutes) it is switches on again.

## 4.3 Overview of parts

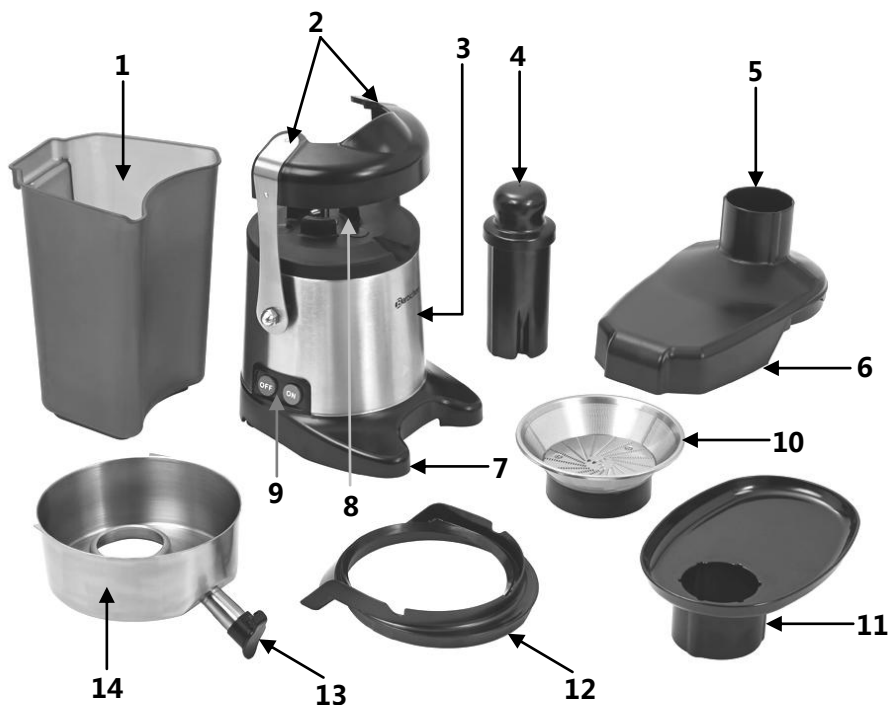

- |                                   |  |
|-----------------------------------|--|
| <b>1</b> Pulp container           | <b>8</b> Motor drive                           |
| <b>2</b> Locking arm with housing | <b>9</b> Control elements                      |
| <b>3</b> Motor base               | <b>10</b> Sieve                                |
| <b>4</b> Plunger                  | <b>11</b> Feed chute tray                      |
| <b>5</b> Feed chute               | <b>12</b> Adapter ring                         |
| <b>6</b> Lid                      | <b>13</b> Juice extraction nozzle with closure |
| <b>7</b> Base with rubber feet    | <b>14</b> Juice bowl                           |

## Control elements



## 5. Installation and operation

### 5.1 Assembly

- Unpack the device and remove the packaging materials.



#### **CAUTION!**

**Do not remove the identification plate or the warning signs from the device.**

- Before use, clean the device according to the guidance in point **6 "Cleaning"**.
- Assemble the device according to **the drawing on page 30** and the description below.

**1**



Place the motor base (**3**) on a dry, flat surface and ensure easy access to the control elements (**9**).

Press the motor base (**3**) towards the surface until the base rubber feet (**7**) cling tightly to the surface.

**2**



Place the juice bowl (**14**) onto the motor base (**3**) and position the juice extraction nozzle with the closure (**13**) above the groove in the base (**7**).

**3**

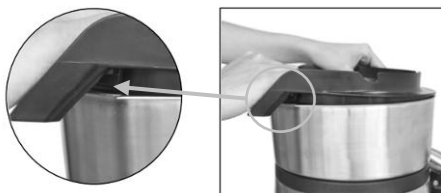

Place the adapter ring (12) at the rim of the juice bowl (14).

Remember to position the pulp spout at the opposite side of the juice extraction nozzle with the closure (13).

**4**



Tilt the sieve (10) position it above the juice bowl (14) and place it on the motor drive (8) by turning slightly to interlock the pin at the motor base with the groove at the bottom of the sieve (10).

**5**



Then, place the lid (6) and remember to properly interlock the protrusions in the lid (6) with the grooves in the adapter ring (12).

**6**



Place the feed chute tray (11) on the feed chute (5). Position the pulp container (1) below the lid (6). For easy cleaning, line the pulp container with the plastic bag.

**7**



Finally, push the locking arm with housing (2) above the lid (6) until they click. As a result, the connection with the safety switch is established.



### **CAUTION!**

The device may operate only when all the elements have been correctly assembled and the locking arm has been interlocked with the safety switch on the lid.

## **5.2 Installation**

### **Positioning**

- Put the device on an even, stable, dry and waterproof surface which is resistant to high temperature.
- **Never** place the device at the edge of a table to avoid tilting or falling.
- The operating surface must be easily accessible and large enough. In order to assure comfortable operation and proper air circulation leave at least 15 cm of space on the sides and back and 50 cm on the front and top from the walls, cabinets, etc.
- **Never** put the device in a moist or wet area.
- **Never** place the device on an inflammable surface.
- Do **not** place the device near open flame, electric heaters or other heat source.
- Place the device so that the plug is easily accessible so as to quickly disconnect the device if the need arises.

### **Connection**



### **DANGER! Electric shock hazard!**

**The device can cause injuries due to improper installation! Before installation and connecting the local power grid specification should be compared with that of the device (see rating plate). Connect the device only in case of compliance!**

**Connect the device only to properly installed single socket with protective terminal.**

- The electrical circuit in the socket must be secured to at least 16A. Only connect the device directly to the wall socket; do not use any extension cords or power strips.

## 5.3 Operation

### Preparing fruits and vegetables



#### CAUTION!

**Before extracting the juice, wash fruits and vegetables thoroughly to remove any pollutants and plant protection products.**

- For the top performance and best taste use only fresh fruit and vegetables.
- The best foods for the juice extractor are apples, pineapples, oranges, grapes, melons, carrots, celery, beetroots and tomatoes.
- Thanks to the particularly big feed chute the juice can be extracted from the whole fruits or vegetables, whereas certain types require additional processing in the form of e.g. peeling, removing seeds, cutting. While preparing fruits and vegetables take into account the instructions and data included in the table below.
- Thin-skinned fruit and vegetables do not require peeling. You can clean them gently with a clean sponge to remove any dirt or wax coating.
- Thick skins from e.g. lemons, oranges or pineapples must be removed.
- Fruits with large seeds and stones, such as mango and papaya and other stone fruits, should have them removed to avoid damage to sieve knives.
- Seeds from some fruits can have a bitter taste. Remove the seeds before extraction of juice from such fruits.
- Cut large fruits and vegetables into smaller pieces. Cone-shaped vegetables and fruits, such as carrots, should be inserted with the thin end first.
- Some food cannot be processed in the juice extractor due to hardness (eg. coconuts).

Fruits / vegetables	Processing
Apples	-
Carrots	-
Beetroots	-
Strawberries	remove stems
Grapes	remove stems
Bananas	peel

Fruits / vegetables	Processing
Mango	peel, remove stones
Pineapple	peel and cut into pieces
Citrus fruits (oranges, lemons, mandarins, grapefruits)	peel
Melons	peel and cut into pieces
Celery roots	cut into pieces of ca. 6 -7 cm
Cucumbers	peel and cut into pieces of ca. 15 cm
Tomatoes	-
Fennel	cut into pieces of ca. 6 -7 cm
Sweet/sour cherries	remove stones
Apricots	remove stones
Peaches	remove stones
Plums	remove stones

## Tips and recommendations

- When preparing juice from different kinds of fruits and vegetables, it can be helpful to combine them based on their characteristics and in various configurations. For example, when juicing apples and oranges, first juice the soft fruit (oranges) then the hard one (apples). This helps make the best juice possible.
- When extracting juice from fresh herbs, e.g. mint or parsley, insert them into the juice extractor between pieces of fruits and vegetables to achieve the best effect . If there is only a small amount of herbs, insert them together with pieces of fruits or vegetables.
- Fruits containing starches (banana, papaya, fig, avocado, mango etc.) are difficult to juice (the generated mousse can clog the sieve). Such fruits may be prepared in a food processor or blender. However, if a given juice flavour requires banana taste, insert bananas into the juice extractor as the first or second piece of fruit. Mixing with other fruit juices will help the banana nectar to flow more easily, but may sometimes result in foaming.
- Small fruits such as grapes or strawberries should be juiced in bunches, not individually. This will provide best juicing results.



- Remember that red beets will colour all other fruits and vegetables. Always juice beets after finishing all other juices to avoid undesired colouring.
- Apple juice quickly turns brown when exposed to air. Add just a hint of lemon juice to it.
- Juice should be served right after squeezing, as with time it will lose taste and nutritional value.
- Never insert ice cubes or frozen fruits to the juice extractor.

## Extracting juice from fruits and vegetables



### CAUTION!

**Never operate the juice extractor when the accessories are properly mounted but no food products have been inserted.**

- Place the proper juice jug under the juice extraction nozzle.
- Plug the device into the single, grounded socket.
- Press **the green switch**.
- Fill the feed chute tray with the ready fruit and vegetables and slowly, by small portions, push with the plunger in the feed chute in the cover.
- Slide the plunger, with a gentle push, on the feed chute. To maximize the juice extraction, move the plunger down slowly. If pushed too hard the juice amount will be reduced, and the device may be damaged.



### WARNING! Hazard of injury!

**Do not push the fruit or vegetables with your fingers.  
Always use the plunger provided!**

- The juice extracted from fruit or vegetables flows through the juice extraction nozzle and is collected in the jug. The pulp is separated and accumulated in the pulp container.
- Add fruit or vegetables until the juice bowl or the pulp container is full.
- Remember to always place the jug under the juice extraction nozzle when extracting the juice. When the jug is full and needs to be removed, close the juice extraction nozzle and reopen it when the jug is replaced.

- Watch the pulp container filling level. When the container is full switch off the device and empty the container.



## **CAUTION!**

**The overfilled pulp container may cause the device to malfunction.  
If the pulp flowing out reaches the motor body it may cause damage.  
Always watch and regularly empty the pulp container!**

- When the juice is extracted from all prepared food leave the device on for a few more seconds to allow the last drops of juice leave the device.
- When the juice extraction is completed switch off the extractor with the **red switch**. Wait a few seconds until the motor stops completely. Only then unplug the device (remove the plug from the socket!) and disassemble for cleaning.



## **WARNING!**

**Remember to keep the device unplugged if not in use,  
or in cleaning, or when removing or placing its parts.**

## **6. Cleaning**



## **WARNING!**

**Disconnect the device from the power supply  
(unplug!) before cleaning.**

**Never clean the device with use of water jet!**

**Be careful and do not let the water into the device.**

### **Cleaning**

- Always clean the device after its use.
- To clean the device immediately after its use, disassemble it in the following order:
  - remove the pulp container and empty it,
  - pull the locking arm out from the lid ,

- remove the feed chute tray from the feed chute,
  - detach the lid from the adapter ring and remove it,
  - carefully take out the sieve from the juice bowl,
  - remove the adapter ring from the juice bowl,
  - remove the juice bowl from the motor base.
- Wash thoroughly the juice bowl, adapter ring, lid, feed chute tray, pulp container and plunger under running water with a mild cleaning agent. Next, rinse with clean water.
  - Place the sieve under running water and clean the outside of the sieve using the appropriate plastic brush. Next, clean the inside of the sieve by brushing it counter clockwise to remove the pulp.
- Tip:** if the fruit pulp sticks to the sieve or dried out, soak the sieve in the hot water for 5 to 10 minutes.
- To ensure that all pulp that could block the sieve have been removed, examine the sieve under a light source.



## **WARNING! Danger of injury!**

**The knives in the sieve are very sharp.**

**To avoid injury, do not touch them with bare hands.**

- Before reassembly, carefully wipe down all the cleaned parts or leave them to dry thoroughly.



## **CAUTION!**

**Never immerse the motor base in running water or any other liquids, do not wash it under running water or in the dishwasher.**

- Wipe the motor base and power cable with a soft, moist cloth. Make sure that no liquids get inside the motor housing or inside the plug. Wipe dry the device thoroughly with a soft, dry cloth.
- Do not use any harsh cleaning agents, abrasive cleaners, acetone, alcohol, etc., as they may damage the surface of the device.

## **Storage**

- If the device is not used for any lengthy period, clean it according to the aforementioned description and store it in dry, clean place protected against cold, sun and children. Do not place any heavy objects on the device.

## 7. Possible Malfunctions

In case of malfunction, disconnect the device from its power source. Before contacting the service or sales agent, verify - based on the table below - whether it is possible to eliminate disruption in operation.

Problem	Possible cause	Solution
<b>The juice extractor does not start after switching on</b>	<ul style="list-style-type: none"> <li>• Plug improperly connected.</li> <li>• Inactive safety switch, check the position of the locking arm.</li> </ul>	<ul style="list-style-type: none"> <li>• Pull the plug and reconnect it to its socket properly.</li> <li>• Follow the instructions of the section 5.1 <b>“Assembly”</b>.</li> </ul>
<b>Strange noise during the operation</b>	<ul style="list-style-type: none"> <li>• Incorrectly assembled juice extractor.</li> <li>• A part of the device is damaged.</li> </ul>	<ul style="list-style-type: none"> <li>• Follow the instructions of the section 5.1 <b>“Assembly”</b>.</li> <li>• Contact the sales agent.</li> </ul>
<b>The device vibrates</b>	<ul style="list-style-type: none"> <li>• The pulp container is full.</li> <li>• Due to the sticking pulp, the sieve cannot keep proper balance.</li> </ul>	<ul style="list-style-type: none"> <li>• Empty the pulp container.</li> <li>• Switch the device off and clean the sieve (follow the instructions of section 6 <b>“Cleaning”</b>).</li> </ul>
<b>The motor appears to struggle during operation</b>	<ul style="list-style-type: none"> <li>• The pulp container is full.</li> </ul>	<ul style="list-style-type: none"> <li>• Empty the pulp container.</li> </ul>
	<ul style="list-style-type: none"> <li>• Pulp is sticking to the lid.</li> </ul>	<ul style="list-style-type: none"> <li>• Switch the device off releasing the locking arm, remove the lid and remove the pulp. Follow the instructions of section 6 <b>“Cleaning”</b>. Reduce the pace of juicing – move the plunger slower in the feed chute.</li> </ul>
	<ul style="list-style-type: none"> <li>• The sieve is clogged by the pulp/pulp after processing a bigger quantity of fibrous fruits/vegetables.</li> </ul>	<ul style="list-style-type: none"> <li>• Stop the extraction, switch the device off and disassemble it according to the instructions of section 6 <b>“Cleaning”</b> and clean the sieve and the lid, if necessary.</li> </ul>

## If you cannot eliminate the disruptions in operation:

- disconnect the device from the power supply (pull the plug!),
- **do not** open the housing,
- contact the sales agent.

## 8. Waste disposal

### Discarding old devices

At the end of its service life the discarded device has to be disposed in accordance with the national regulations. It is advisable to contact a company which is specialized in waste disposal, or just contact the local disposal service in your community.



### **WARNING!**

**To exclude any abuse and the dangers involved make the waste device unfit for use before disposal.**

**For that purpose disconnect device from mains supply and remove mains connection cable from the device.**



### **CAUTION!**



**For the disposal of the device please consider and act according to the national and local rules and regulations.**

Bartscher GmbH  
Franz-Kleine-Str. 28  
33154 Salzkotten  
Germany

phone: +49 (0) 5258 971-0  
fax: +49 (0) 5258 971-120